

**AROMA<sup>®</sup>**  
**PROFESSIONAL<sup>™</sup>**

High Performance  
Blender



**Questions or concerns about your blender?**  
*Before returning to the store...*



*Aroma's customer service experts are happy to help.*  
**Call us toll-free at 1-800-276-6286**



*Answers to many common questions and even replacement parts can be found online. Visit*  
**[www.AromaCo.com/Support](http://www.AromaCo.com/Support).**

# GETTING STARTED

Thank you for choosing Aroma! The Aroma Professional Blender is designed to promote a diet that's both delicious and healthy. It enables you to effortlessly produce nourishing food and drinks including whole fruit and vegetable juices, power-packed smoothies, warm soups, zesty dressings and sauces, baby food and so much more!

This manual contains instructions for using your blender and its convenient settings, as well as all of the accessories included.

For more information on your Aroma blender, or for product service, recipes and other home appliance solutions, please visit us online at **www.AromaCo.com**.

See what's cooking with Aroma® online!



[www.AromaTestKitchen.com](http://www.AromaTestKitchen.com)



[www.facebook.com/AromaHousewares](https://www.facebook.com/AromaHousewares)



[www.pinterest.com/aromahousewares](https://www.pinterest.com/aromahousewares)



[www.twitter.com/AromaHousewares](https://www.twitter.com/AromaHousewares)

Published By:  
Aroma Housewares Co.  
6469 Flanders Drive  
San Diego, CA 92121  
U.S.A.  
1-800-276-6286  
[www.AromaCo.com](http://www.AromaCo.com)  
©2014 Aroma Housewares Company  
All rights reserved.



## IMPORTANT SAFEGUARDS

**WARNING:** Serious personal injuries can occur with any blender if it is not used properly. To avoid such risks, always follow the following basic safety precautions:

- 1. Read all instructions, safeguards, and warnings before operating.**
- To prevent risk of electric shock, never place the blender base in water or other liquids. See instruction for cleaning.
- This appliance should not be used by or near children or incapacitated persons, and extra caution should be exercised when used near them.
- Unplug from power outlet when not in use and before assembly, disassembly, or cleaning.
- Avoid contact with moving parts, especially the blade.
- Do not operate any appliance with a damaged cord or plug or after the appliance malfunctions or is dropped or damaged in any matter. Contact Aroma Customer Support at 1-800-276-6286 for examination, repair, or electrical or mechanical adjustment.
- The use of third party attachments or accessories such as canning jars, tampers, or blades not explicitly recommended or sold by Aroma may cause fire, electric shock, contamination of food, or injury.
- Do not use outdoors.
- Do not let the power cord hang over the edge of the table or counter.
- Do not let the power cord contact hot surfaces, including the stove.
- Do not let the power cord be submerged in or exposed to water or any liquids. Always ensure that the cord and plug are dry before plugging into a power outlet.
- Keep hands and utensils out of the blender container while operating to prevent the possibility of severe personal injury and/or damage to the blender.
- Blades are sharp; handle with care. To avoid injury, never place the blade assembly on the base without the container attached properly.
- Always make sure the Container Lid is in place while operating.
- Do not blend hot liquids.
- Do not leave the blender unattended while operating.
- This product is for HOUSEHOLD USE ONLY.
- Do not blend extremely hard ingredients such as rock sugar or peach seeds in this product.
- Always unplug from the base of the wall outlet. Never pull on the cord.
- To disconnect, turn any control to OFF, then remove plug from wall outlet.
- Use only on a level, dry and heat-resistance surface.

*Failure to follow any of these steps can void your warranty and create the risk of serious injury.*

**SAVE THESE INSTRUCTIONS**



## IMPORTANT SAFEGUARDS



- Use this product with rated voltage AC outlets only. Make sure to unplug the Power Cord when the blender is not being used.

### Short Cord Instructions

1. A short power-supply cord is provided to reduce the risks resulting from becoming entangled in or tripping over a longer cord.
2. Longer extension cords are available and may be used if care is exercised in their use.
3. If a longer extension cord is used:
  - a. The marked electrical rating of the extension cord should be at least as great as the electrical rating of the appliance.
  - b. The longer cord should be arranged so that it will not drape over the counter top or tabletop where it can be pulled by children or tripped over unintentionally.

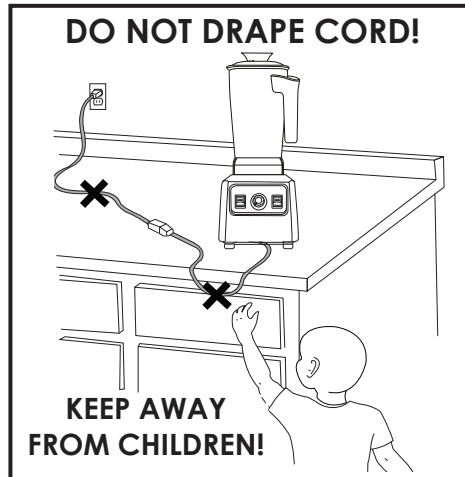

### Polarized Plug

This appliance has a **polarized plug** (one blade is wider than the other); follow the instructions below:

To reduce the risk of electric shock, this plug is intended to fit into a polarized outlet only one way. If the plug does not fit fully into the outlet, reverse the plug. If it still does not fit, contact a qualified electrician. Do not attempt to modify the plug in any way.

If the supply cord is damaged, it must be replaced by the manufacturer, its service agent or a similarly qualified person in order to avoid a hazard.

*Failure to follow any of these steps can void your warranty and create the risk of serious injury.*



## IMPORTANT SAFEGUARDS

### OVERLOAD FAIL SAFE

For safety, the core motor is equipped with a built in circuit breaker that will automatically shut off in case of an electrical overload. To reset the unit after an automatic shut off, simply press the red circuit breaker reset button located at the bottom of the base.

The core motor is also equipped with a temperature guard system to prevent damage from overheating and will automatically shut off if the temperature ever exceeds 125°C. The unit will be ready to resume function as soon as the motor cools down.



## ADDITIONAL SAFETY CONSIDERATIONS

1. Do not open the Container Lid until the blades have completely stopped turning.
2. Unplug the power cord after each use.
3. Do not submerge the base of the blender in water or other liquids. The base is NOT dishwasher safe.
4. Do not leave foreign objects, such as spoons, forks, or knives, in the container when starting the blender as this may cause damage as well as serious personal injury.
5. Make sure that the blender and motor assembly are firmly affixed to the blender base before turning on the blender.
6. To avoid risk of injury from blades, always use a spoon or the included rubber spatula to remove food from the blender.

*Failure to follow any of these steps can void your warranty and create the risk of serious injury.*

# PARTS AND FEATURES



# PARTS AND FEATURES

## CONTAINER ATTACHMENTS

### FILTERS

Your Aroma Professional blender comes with two filters: a Fine Filter (thin mesh) for ingredients with high fiber content, and a Coarse Filter (wide mesh) for filtering pulp from juices.

Insert a Filter by sliding the narrow end into the slot on the inside of the Container on the side of the pouring spout with the curve of the Filter matching the curve of the Container.

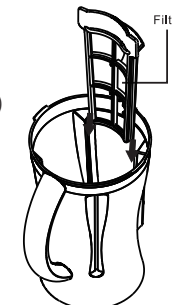

- Make sure the Filter comes in contact with the bottom of the Container and is secure. The Filter should not wiggle if inserted properly.

### REMOVABLE SPOUT

A Removable Spout can be attached to the drain at the side of the Container for easy dispensing of juice blends.

To attach the Removable Spout, first remove Drain Cap from drain from the side of the Container by unscrewing it. Screw the pipe end of the Removable Spout over the drain until it stops turning.

To dispense, place a cup or bowl underneath the opening and pull up on the lever on the Removable Spout until it locks in place. To stop dispensing, simply push the lever back into its original position.

**TIP:** For best results, operate the Removable Spout while the blender is still running, as the pressure from the blending helps with the flow.

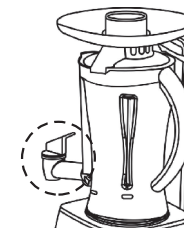

- For best results, operate the Removable Spout while the blender is still running, as the pressure from the blending helps with the flow.



- Make sure either the Removable Spout or Drain Cap is attached to the Container before pouring in liquids or operating the blender to prevent spillage. Do not operate or add ingredients into the Container with the drain uncovered.



- If the Removable Spout is attached, make sure the dispenser is closed before pouring in liquids or operating the blender to prevent spillage

# PARTS AND FEATURES

## CONTAINER LID AND SAFETY LOCK

### LOCKING CONTAINER LID

The Aroma Professional blender comes with a heat resistant, easy to clean lid with an opening to accommodate the included Lid Cap and Funnel. To place the Container Lid on the Container properly, first ensure that the lever on the Container Lid is in the unlocked position. Align the jugged corner of the Container Lid with the pour spout on the Container and press down firmly.

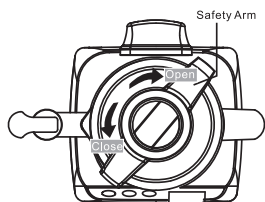
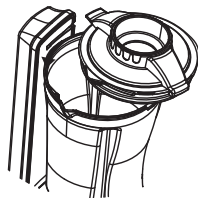

To lock the Container Lid in place, first ensure that the Container is secured properly on the Base with the handle on the side with the Arrow Marker. Rotate the lever on the Container Lid counter-clockwise until it slides all the way into the slot on the Safety Mechanism and locks in place.

To remove the Container Lid, rotate the lever clockwise to unlock. While holding the Container down in place by the handle, lift the Container Lid by the jugged corner.



#### NOTE

- The blender will not function unless the Container Lid is properly locked in place.



#### WARNING

- To avoid splashing, make sure the Lid is always on while the machine is running.

### LID CAP

The Lid Cap features wide and narrow ends to accommodate use both directly with the Container Lid and through the included Funnel. With the Container Lid secure, insert the Lid Cap directly by fitting the wide end into the opening and pressing down until it is tightly secure. To remove, hold the Container Lid down with one hand while twisting the Lid Cap until it is loose enough to remove.

### FUNNEL

With the Container Lid secure, insert the narrow end of the funnel into the opening to make it easier to pour liquids or finer foods into the Container without spilling. To fit the Lid Cap in over the Funnel, simply insert the narrow end into the opening.

# PARTS AND FEATURES

### BLADES

The Aroma Professional blender comes equipped with a unique cow-horn shaped set of powerful serrated blades made of SUS420 stainless steel. Keep the blades clean and dry when not in use to prevent rust.



#### WARNING

- Blades are sharp and can cause serious injury. Do not put hands into the Container while the blender is on or if the Container is on the base.

### CONTROL PANEL

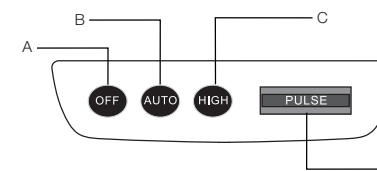

- A. OFF BUTTON:** Power off the machine while it is running.
- B. AUTO BUTTON:** The motor will operate for 4 seconds then stop for 2 seconds for a total of five cycles. The motor will then operate continuously for 30 seconds before stopping for a total blending time of 60 seconds.
- C. HIGH BUTTON:** The motor will run continuously for 60 seconds.
- D. PULSE LEVER:** The motor will operate when the lever is pressed down and stop when it is released. The Pulse Lever is designed for 2 to 3 seconds bursts only. For longer blending/juicing periods, use either the Auto or High Buttons.



#### NOTE

- The blender will not function unless the Container Lid is properly locked in place with the Safety Mechanism.

# OPERATING INSTRUCTIONS

1. Insert the appropriate Filter if desired.
2. Load the ingredients into the Container. When pouring in liquids, the water level should cover the blades.
3. Cover with the Container Lid and secure the Lid Cap.
4. Set the Container firmly on the Base by matching the handle with the arrow marking on the base.
5. Lock the Container Lid into the Safety Mechanism.
6. Blend using the Auto or High Buttons or Pulse Lever.
7. To add additional ingredients, remove the Lid Cap and add ingredients using the Funnel. Once the contents are pureed, add water or ice until it reaches the desired volume and/or thickness.
8. For juices, feel free to dispense through the Removable Spout while the blender is still running.
9. Wait for the blender to stop automatically, or stop it manually by using the Off Button.



- When making Jam Purees, fruits high in water content such as strawberries do not need any additional water. Add sugar to the ingredients and blend until pureed. Pour the contents into a double boiler and allow it to cook for 10 to 15 minutes. Allow to cool before serving.

# CLEANING AND CARE

*To ensure the longevity of your Aroma Professional blender, always make sure to clean after each use. Please follow the following tips for cleaning:*

- Wash the Container, Removable Spout, Container Lid, Funnel, Lid Cap, and Filters separately in warm soapy water.
- Rinse in clean fresh water.
- Dry out the excess water from the Container with a dry rag or towel.
- Stand the Container right side up and allow it to air dry thoroughly before storage to prevent odors or rust.
- To eliminate odors, blend two slices of lemon with 4 cups of water in the Container. Let sit for a few minutes before rinsing out with water and drying.
- Filters can be cleaned with a toothbrush.
- To help prevent rust, the blades can be dried further by running the machine for 1 second with the Container empty.



- Make sure the outside of the Container and the Power Axle are thoroughly dried before placing the Container back on the Base.

- The Removable Spout can be cleaned more thoroughly by unscrewing the silver cap below the lever and pulling out the silicon sleeve.



## TROUBLESHOOTING



WARNING

- For your safety, always make sure the Power Cord is unplugged before troubleshooting.

### **My blender will not start.**

Check to see if the Container Lid is properly secured. For safety reasons, the ABD-650 will not start unless the lever on the Container Lid is correctly locked into the slot on the Safety Mechanism.

Double check the power cord to make sure that it is properly plugged in. Press the circuit breaker reset button located on the bottom of the base. If the device still does not work, call Aroma Customer Service at 1-800-276-6286.

### **My blender stopped suddenly mid-use and I cannot get it to start again.**

It is possible that your blender has overloaded or overheated. Your Aroma Professional blender is equipped with an automatic overload fail-safe that automatically shuts off the machine for safety when overloaded with electricity or heat (see page 4). To reset the unit after an automatic shut off, simply press the red circuit breaker reset button located on the bottom of the base.

In case of overheating, simply wait 15 minutes for the motor to cool, and the unit should resume functionality.

### **The blade does not rotate smoothly and the machine makes loud abnormal sounds.**

The retainer nut in the Container may have come loose. Stop using immediately and contact Aroma Customer Service.



## LIMITED WARRANTY

Aroma Housewares Company warrants this product free from defects in material and workmanship for one year from provable date of purchase in the continental United States.

Within this warranty period, Aroma Housewares Company will repair or replace, at its option, defective parts at no charge, provided the product is returned, freight prepaid with proof of purchase and U.S. \$25.00 for shipping and handling charges payable to Aroma Housewares Company. Before returning an item, please call the toll free number below for a return authorization number. Allow 2-4 weeks for return shipping.

This warranty does not cover improper installation, misuse, abuse or neglect on the part of the owner. Warranty is also invalid in any case that the product is taken apart or serviced by an unauthorized service station.

This warranty gives you specific legal rights and which may vary from state to state and does not cover areas outside the United States.

AROMA HOUSEWARES COMPANY  
6469 Flanders Drive  
San Diego, California 92121  
1-800-276-6286  
M-F, 8:30 AM - 5:00 PM, Pacific Time  
Website: [www.AromaCo.com](http://www.AromaCo.com)

